

SET 1/2" REBAR AT NW COR.

SW1/4-NW1/4, SEC. 16

T-2-N, R-8-W

CORNER REFERENCES:

BOLT BRS S23°54'E-23.4'

"T" IRON BRS N65°15'E-14.4'

5/8" RB BRS S50°40'E-11.3'

CORNER REFERENCES:

PP BRS N08°21'E-14'

FC BRS N45°W-0.3"

10' WEST OF CL OF DRIVE

FOUND 1-1/4" PIPE

USED AS NE COR.

SW1/4-NW1/4, SEC. 16

T-2-N, R-8-W

P.O.B.

SET 1/2"

REBAR W/CAP

S89°34'24"E

1167.26'

S89°34'24"E 177.77'

25' EASEMENT

1-STORY
BRICK RESIDENCE

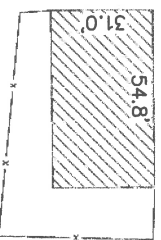

N01°50'31"E 245.03'

SW1/4-NW1/4,
SEC. 16, T2N-R8W
1.00 AC. +/-

S01°50'31"W 245.03'

ASPHALT DRIVE

SET 1/2"
REBAR W/CAP

N89°34'24"W 177.77'

SET 1/2"
REBAR W/CAP
3.0' WEST OF
FENCE

S01°50'31"W
1069.47'

PROPERTY DESCRIPTION FROM SURVEY:
A PART OF THE SOUTHWEST QUARTER
OF THE NORTHWEST QUARTER OF
SECTION 16, TOWNSHIP 02 NORTH,
RANGE 08 WEST, LONOKE COUNTY,
ARKANSAS, BEING MORE PARTICULARLY
DESCRIBED AS FOLLOWS:
BEGINNING AT A FOUND 1-1/4" PIPE
BEING USED AS THE NORTHEAST
CORNER OF THE SOUTHWEST QUARTER
OF THE NORTHWEST QUARTER OF
SECTION 16, THENCE SOUTH 01 DEGREES
50 MINUTES 31 SECONDS WEST ALONG
THE EAST LINE OF THE SAID
SOUTHWEST QUARTER OF THE
NORTHWEST QUARTER A DISTANCE OF
245.03 FEET TO A SET 1/2" REBAR;
THENCE NORTH 89 DEGREES 34 MINUTES
24 SECONDS WEST LEAVING SAID EAST
LINE A DISTANCE OF 177.77 FEET TO A
SET 1/2" REBAR; THENCE NORTH 01
DEGREES 50 MINUTES 31 SECONDS EAST
A DISTANCE OF 245.03 FEET TO A SET
1/2" REBAR ON THE NORTH LINE OF
THE SAID SOUTHWEST QUARTER OF THE
NORTHWEST QUARTER; THENCE SOUTH
89 DEGREES 34 MINUTES 24 SECONDS
EAST ALONG SAID NORTH LINE A
DISTANCE OF 177.77 FEET, RETURNING
TO THE POINT OF BEGINNING,
CONTAINING 1.00 ACRE, MORE OR LESS.
THE NORTH 25 FEET OF THE PROPERTY
IS RESERVED FOR INGRESS/EGRESS
EASEMENT.

BASIS OF BEARING:
NAD 83 GRID NORTH
ARSP NORTH ZONE

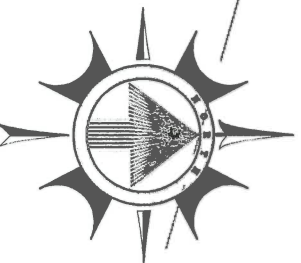

0 60 120
SCALE: 1" = 60'

CALCULATED SE COR
SW1/4-NW1/4, SEC. 16
T-2-N, R-8-W

PROPERTY SURVEY FOR THE HEIRS OF FLOYD WATSON LOCATED IN
PART OF THE WEST 1/2 OF SECTION 16 AND PART OF THE SE1/4 OF THE
NE1/4 OF SECTION 17, T-2-N, R-8-W, LONOKE COUNTY, ARKANSAS.

CRYE SURVEYING, LLC.

302 SOUTH 2ND STREET, CABOT, ARKANSAS 72023
(OFFICE 501-941-3006) (CELL 501-516-6663)

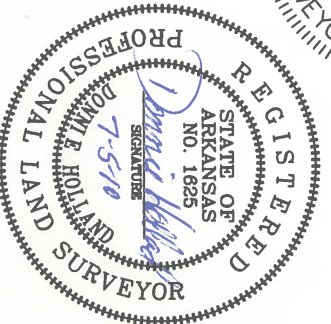
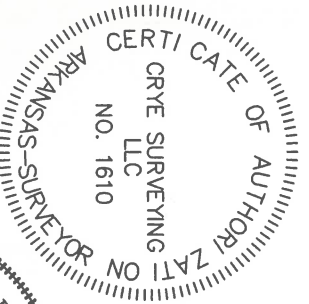

I HEREBY CERTIFY THAT THIS IS THE RESULTS OF A FIELD
SURVEY MADE BY
ME AND UNDER MY SUPERVISION, JULY 5, 2010.
THE CERTIFICATION OF THE SURVEY EXPIRES NINETY DAYS FOR
OF THE DATE
OF THE SURVEYOR'S SIGNATURE FOR THE PURPOSE OF NEW OR
REVISED FINANCING.
THIS SURVEY AND CERTIFICATION IS THE PROPERTY OF THE
SURVEYOR AND IS
INTENDED FOR THE USE AND BENEFIT OF THE SURVEYOR AND
CLIENTS LISTED.
THERE ARE ONLY VISIBLE EASEMENTS AND ENCROACHMENTS
ONTO OR FROM THIS
PROPERTY AS SHOWN.
NO UNDERGROUND LOCATION OF UTILITIES ARE CERTIFIED BY
THE SURVEY.

FILE NAME: CHARLES WATSON

DATE: JULY 5, 2010

SURVEY PLAT CODE: 500-02N-08W-0-16-304-43-1352
500-02N-08W-0-17-120-43-1352

ONLY COPIES WITH
SURVEYOR'S SIGNATURE
ARE VALID COPIES