

-Surveyor's Notes-

1. Basis of Bearings for this survey is Grid North, Arkansas South Zone.
2. This survey is based on documents as provided by the client and does not constitute a title search by the Surveyor. A thorough search of the records was performed by the Surveyor, however, there may exist other documents of record that may affect this parcel.
3. All visible encroachments, as of the date of this survey, are shown hereon.
4. Field Work Completed on 29 Jan 2019.

-Legend-

- - Found Mon. as Noted
- - Set 1/2" Rebar w/Cap PS 1491
- △ - Computed Point
- ▲ - Set PK Nail
- - Fence Corner

-Certification-

This is to certify that the above described land has been surveyed by me, or under my direct supervision. All corners are marked as shown and are in accordance with existing monuments found in the vicinity. This certification is for and limited to the parties shown hereon. This survey is valid only if print has original seal and signature of surveyor.

-Surveyed Description-

A tract of land being situated in the NW 1/4 SE 1/4 of Section 12, Township 6 South, Range 26 West of the Fifth Principal Meridian, being located in Pike County, Arkansas, and being more particularly described as follows:

Commencing at an Aluminum Monument for the NW Corner of Said NW 1/4 SE 1/4, Thence S 87°18'43" E, 694.73 Feet along the North Line of Said NW 1/4 SE 1/4; Thence S 01°40'17" W, 166.31 Feet to the Point of Beginning; Thence S 01°40'17" W, 382.32 Feet to a Rebar on the North Right-of-Way of Arkansas Highway 70; Thence along a nontangent Curve to the Left having a radius of 2886.36 Feet, an arc distance of 254.71 Feet, the chord of which bears N 71°52'37" E, 254.62 Feet; Thence N 69°20'56" E, 214.84 Feet along Said Right-of-Way to a Rebar; Thence N 11°57'26" W, 327.34 Feet to a Rebar; Thence S 75°39'44" W, 375.76 Feet to the Point of Beginning, Containing ±3.37 Acres more or less and being subject to any and all covenants, easements, and restrictions of record.

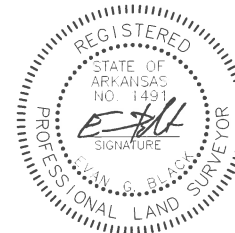

Scale is for 11" x 17" Drawing State Land Surveyor's Plot Filing Code: 500-06S-26W-0-12-240-55-1491	
Boundary Survey Part of the NW 1/4 SE 1/4 Section 12, T6S-R26W Pike County, Arkansas	
Prepared For: David Simon	
Black Land Services, Inc. Evan G. Black, PS P.O. Box 289, Royal, Arkansas 71968 (501) 622-9859	
Drawn By: EGB Scale: 1"=100' Date: 4 Feb 2019 Job Number: 1916 Field Book: 065 File Name: 1916 rev.dwg Revisions: 1) revised bndy	